

# **Tire Pressure Monitoring System**

## **Instruction Manual SK-1**

**TPMS**



## 1. Internal sensor

The factory has already set up the codes for all the sensors which are provided and matched with the monitor, and each sensor is marked with the corresponding tire position (LF, RF, LR, RR, ST; LF=Left Front Tire, RF=Right Front Tire, LR=Left Rear Tire, RR=Right Rear Tire, ST=Spare Tire), Please install each sensor in the correct tire position as per the right diagram .

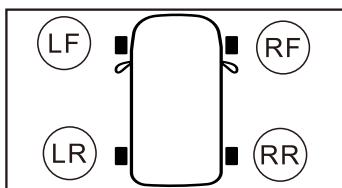

**Note:** In order that the monitor can receive the sensor data immediately, please make sure the monitor is power on before installing the sensor

## Sensor Installation Steps:

Unload the tire from the vehicle. Deflate the tire and take the rubber tire out of the rim. Take out the valve on the rim and replace with the sensor.

- (1). Unload the tire from the vehicle. Deflate and take the rubber tire out of the rim.
- (2). Take out the valve on the rim and replace the valve with the sensor.

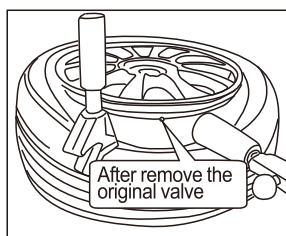
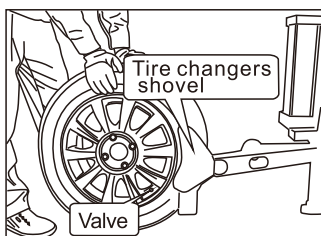

**CAUTION:** DONOT shovel above the sensor if the tire has been installed with TPMS sensor. In order not to damage the sensor, please be sure to shovel 15cm away from the sensor.

(3). Install the dust cap to the sensor valve, apply some liquid soap or lubricant to the valve, then take the dust cap as the front part to install the sensor into the rim. When the sensor valve is tightly installed in the rim and could not be moved, the sensor installation is done.

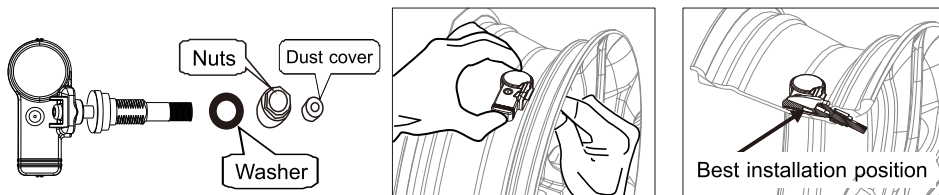

Sensor position after installation:

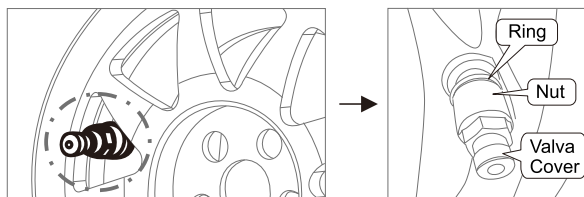

(5). Install the rubber tire onto the tire rim, be sure not to damage the sensor. Inflate the tire and do the balancing. ( Check if there is leakage of the tire. ) Install the dust cap onto the sensor. Install the tire back to the vehicle.

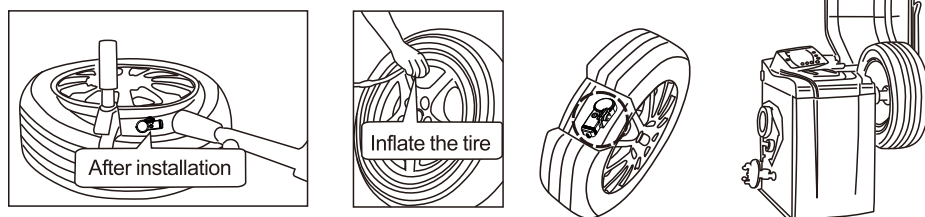

## CAUTION:

- (1). These sensor installation above should be carried on by professional person.
- (2). Be sure not to damage the sensor while unload or install the tire.
- (3). Each sensor has been marked with different number, please install the sensors to the right position.
- (4). There will be low battery alert while the sensor battery voltage is low.
- (5). Soap bubbles should be used to check the tire valve if there is leakage after sensor installation.

## 2. SPECIFICATIONS

	Internal sensor
Operation Temperature	-40°C to 80°C
Storage Temperature	-40°C to 85°C
Pressure Range	0 to 116 psi (0 to 8 bar)
Pressure Accuracy	± 1.5 psi( ± 0.1 bar)
Temperature Accuracy	± 3°C
Transmission Power	<10dBm
Transmission Frequency	433.92MHz
Battery life	≥ 3 years
Size	54 (L) x 76(W) x 19(H) mm
Weight	29g